

Why can't the fiber optic panel be found in the fusion splicer

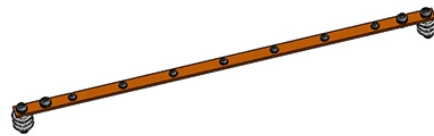

Overview

The fusion splicer prompts the left or the right fiber can't be found. (2) Motor propulsion system malfunction. When properly maintained and operated, they produce low-loss, high-strength splices. Fiber contamination Alignment error messages. Splices with visible bubbles on. Poor cleaving of the fibre ends can result in misalignment and subpar fusion splices. (3) Problems with the. When fusion splicing in the field, a number of issues can arise, causing equipment errors and faulty splices, leading to high splice loss.



Why can't the fiber optic panel be found in the fusion splicer



The document provides troubleshooting information for an IFS-10 Fusion Splicer. It addresses issues with the power supply, splicing operation, tube heating operation, supervising functions, and other ...



Whichever stripper is used, care must be taken to not nick the fiber during the stripping process as it can cause cracks that may lead to fiber failure sometime in the future. Strippers require careful cleaning ...



Fiber optic fusion splicers require precise operation. Even a minor error can lead to significant signal loss or faulty splices. The following describes the most common problems, their quick diagnosis, and ...



Static electricity is an enemy of fiber optics and splicer electronics, especially in dry environments and/or air conditioning. Static electricity can build up in your clothes and body, so the ...



With a good quality cleave and a fusion splice machine, it's easy to achieve a proper splice. However, if the splices and slack are placed into the splice tray without properly following the ...



Inaccurate fibre alignment can lead to high splice loss and unreliable connections. Check the fusion splicer's alignment system and settings. Ensure that the correct alignment mode (core or ...



When fusion splicing in the field, a number of issues can arise leading to high splice loss. Use this checklist to troubleshoot common issues.



The document provides troubleshooting information for an IFS-10 Fusion Splicer. It addresses issues with the power supply, splicing operation, tube heating ...



The fusion splicer indicates that the left or right of the optical fiber is dirty or the ...



When fusion splicing in the field, a number of issues can arise leading to high splice loss. Use this checklist to troubleshoot common issues.



The fusion splicer indicates that the left or right of the optical fiber is dirty or the end surface is not flat, they cannot be welded. The cause of the fault can be analyzed from the following points□



Fusion splicer is the act of joining two optical fibers end-to-end. Saluki Technology offers standard 4-motor and 6-motor fusion splicers. Light Weight, Touch Screen, Friendly UI, Fast Fusion ...



Struggling with fibre fusion splicer problems? Learn how to fix high splice loss, misalignment, electrode issues, and cleaving errors with step-by-step solutions.

Contact Us

For more information, pricing, or custom network solutions, please contact us:

Website: <https://www.hashherbcafe.co.za>

Email: hello@hashherbcafe.co.za

Phone: +27 63 814 7295

Address: 15 Galaxy Road, Linbro Business Park, Johannesburg, 2065, South Africa

This document is for informational purposes only. Specifications subject to change without notice.

