

## Quantity of fiber optic splice closures



### Overview

These charts represent the capacities of each of the FOSC 450 closure sizes. Capacities may vary due to application variables, such as the amount of slack storage required. They are engineered systems designed to protect fiber splices from mechanical stress, environmental exposure, and long-term performance degradation. This guide is written to provide a complete and engineering-oriented understanding of fiber optic splice closures—from basic concepts and. Gator 12F Fiber Optic Splice Closure, Re-enterable, Gel Cable sealing, for up to 12 splices Finish making your selections or clear them to view relevant specifications. Looking for Build America Buy America (BABA) products?

. To prove. COYOTE Closure, 288f/576f ribbon max, Buffer Tube: 8. 5" x 22", Includes (1) 3 Section End Plate, (1) Blank End Plate, Organizer, and Lock Tape sealant. FOSC 600 D Dome Closure, 648ct Single/1728ct Ribbon, 8 Ports, Loaded Without Trays, 4 Ground Lugs, 32. Fiber splice enclosure box is used for. The selection of the appropriate fiber optic splice closure can be a very daunting task.

## Quantity of fiber optic splice closures

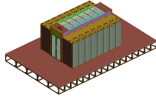

This guide is written to provide a complete and engineering-oriented understanding of fiber optic splice closures—from basic concepts and classifications to structural logic and practical ...



Some splice closures have all cables entering into one end, usually called dome closures or sometimes called a butt closure, while some have cable entries on both ends, sometimes called inline closures.



The selection process can involve many factors such as the number of cables, the splicing environment, the number of fibers, and many other options. This note will focus on reducing the total number of ...



Gator 12F Fiber Optic Splice Closure, Re-enterable, Gel Cable sealing, for up to 12 splices



FOSC 450 fiber optic splice closures can be ordered in a variety of configurations to maximize efficiency and minimize up front cost. The following pages provide closure choices and the steps to be followed ...



These closures use compression grommet sealing technology to provide a robust and easy to use economical IP68 rated solution. Charles offers two sizes of FODC that accommodate up to 144 ...



The largest of the FOSC closure family, 600 fiber optic splice closures are a great fit for applications such as large cable splicing in the network backbone, consolidating a large number of cables and ...



Horizontal type fiber cable joint box is more popular than vertical type (dome type) closure. The capacity of splice is from 24 fiber to max 192 fiber. Copperled is a professional fiber enclosure box ...



FOSC® 450 C6 Fiber Optic Splice Closure, Gel Cable sealing, no pre-installed tray, 6 cable attach., three ground feedthrough lugs, with test valve. Price per each.



This guide is written to provide a complete and engineering-oriented understanding of fiber optic splice closures—from basic concepts and ...

## Contact Us

For more information, pricing, or custom network solutions, please contact us:

Website: <https://www.hashherbcafe.co.za>

Email: [hello@hashherbcafe.co.za](mailto:hello@hashherbcafe.co.za)

Phone: +27 63 814 7295

Address: 15 Galaxy Road, Linbro Business Park, Johannesburg, 2065, South Africa

This document is for informational purposes only. Specifications subject to change without notice.

