

# **Palestinian Fiber Optic Cable Junction Box**



## Palestinian Fiber Optic Cable Junction Box



The 4.4-core FTTH fiber optic distribution box is an interface device for connecting ...

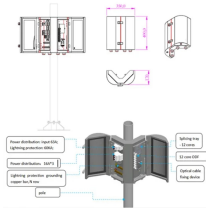

The GR.TFO splice boxes in glass fiber reinforced IP66 polyester enclosures enable safe protection of fiber optic cable splices in hazardous areas. Each of these sturdy splice boxes can hold up to 8 ...



This product is designed specifically to provide a safe and secure connection between fiber optic cables. This junction box is made from strong, durable steel, and it has a convenient 415X340X122.5 ...



Underground vaults are used to link fiber optic cables or power, communications cables placed inside innerduct conduit. Orders are by truckload, call for details. The standard is to place an underground ...



With the increasing digitization and requirement for high-speed networking, the Bartec Technor junction boxes for fiber optic signals performs dependably in the harshest of environments.



The 4.4-core FTTH fiber optic distribution box is an interface device for connecting trunk optical cables and distribution optical cables outdoors, corridors or indoors.



We offer fiber optic contracting services including Aerial (Low & High Tension) & direct burial cables, and FTTx technologies. Our team has extensive experience in rolling, installing,...



Optical cable joint box is suitable for the installation and use of overhead, pipeline, direct burial and other laying methods in communication, broadcasting and television optical cable lines



Find your fiber optic junction box easily amongst the 67 products from the leading brands (HUBER+SUHNER, BOPLA, METZ CONNECT, ...) on DirectIndustry, the industry specialist for your ...



Suitable for wiring connections between optical cables and optical communication equipment. Through adapters in the wiring box, optical signals are led out using optical jumpers to achieve optical wiring ...



Reliable manufacturer of fiber optic passive: fiber optic cross cabinet in Palestine, PLC Splitter, Adapter, Optical Cable Cross Connection Cabinet, Fiber Optic Patch Cord, FTTH Terminal Box, Splice ...

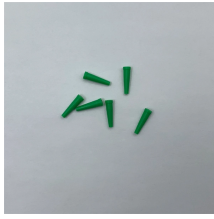

Optical cable joint box is suitable for the installation and use of overhead, pipeline, ...

## Contact Us

For more information, pricing, or custom network solutions, please contact us:

Website: <https://www.hashherbcafe.co.za>

Email: [hello@hashherbcafe.co.za](mailto:hello@hashherbcafe.co.za)

Phone: +27 63 814 7295

Address: 15 Galaxy Road, Linbro Business Park, Johannesburg, 2065, South Africa

This document is for informational purposes only. Specifications subject to change without notice.

