

Install the 25G core switch

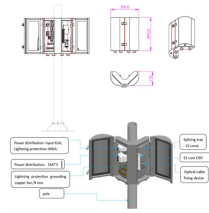

Install the 25G core switch



The SparX-5 switch family features a highly flexible set of Ethernet ports with support for 25G aggregation links, QSGMII, USGMII, and USXGMII. The device integrates a powerful 1 GHz dual ...



Implements the 25G Ethernet Media Access Controller (MAC) with a Physical Coding Sublayer (PCS) as specified by the 25G Ethernet Consortium. MAC and PCS/PMA or PCS/PMA ...



Whether you are upgrading a data center network, deploying 25G spine-leaf architecture, or evaluating third-party optics, this guide will help you determine if an SFP28 25G LR module is the right choice ...



These documents contain important safety and environmental information along with specific installation instructions and specifications for the Cloud Pak for Data System building blocks.



The switch implements 48 SFP28 25 GbE and 12 QSFP28 100 GbE ports in the 1RU chassis. The built-in switch chip provides bandwidth up to 3.2 Tbps and can provide line-speed L2 and L3 switching, ...



In a compact 1RU form factor, the switch provides line-rate L2 and L3 switching across the 48 x SFP28 + 8 x QSFP28 ports, and each QSFP28 port can be configured as 4 x 25 GbE, 1 x 40 ...



Edge to core stackable platform, from 1 Gigabit to 100 Gigabit, all within 15.75in (40cm) of depth. A simplified user interface makes it easy to assign configuration profiles to each port. NETGEAR IGMP ...



I'm about to decide on a switch for 25Gbps with possibility to upgrade even further so I'm trying to decide between MikroTik CRS510-8XS-2XQ-IN or MikroTik CRS518-16XS-2XQ-RM around ...



To install the Edge-corE AS7326-56X switch in a rack, follow these steps as outlined in the user guide: 1. ****Attach the Brackets:**** - Attach each of the fr ...



Warning: For a safe and reliable installation, use only the accessories and screws provided with the device. Use of other accessories and screws could result in damage to the unit.

Contact Us

For more information, pricing, or custom network solutions, please contact us:

Website: <https://www.hashherbcafe.co.za>

Email: hello@hashherbcafe.co.za

Phone: +27 63 814 7295

Address: 15 Galaxy Road, Linbro Business Park, Johannesburg, 2065, South Africa

This document is for informational purposes only. Specifications subject to change without notice.

