

Core Switch 100Mbps Ethernet Port Board



Core Switch 100Mbps Ethernet Port Board



This is an ETH development board based on ESP32-S3R8, supports Wi-Fi and ...



Buy 10/100mbps ethernet switch circuit board for module 10/100mbps 5port switch PCBA board OEM Motherboard ethernet switch 5 RJ45 at Aliexpress for . Find more 13, 200328240 and 200321150 ...

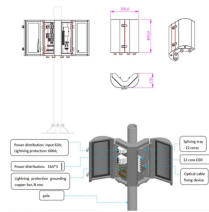

This is an ETH development board based on ESP32-S3R8, supports Wi-Fi and Bluetooth wireless communication, with reliable and efficient wired Ethernet connectivity, optional for PoE function.

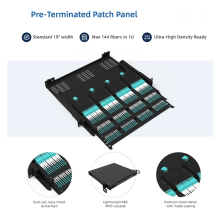

Buy PCI Quad Fast Ethernet Switch Board 100Mbps Realtek PCI V2.2 RTL8305+8100CL Chipset 4 Port RJ45 Network Switch Lan Card with fast shipping and top-rated customer service.



Support IEEE 802.3x flow control for full duplex mode and backpressure for half duplex mode on all port Non-blocking switching architecture that forward and filter packets at wire-speed for maximum ...



This is an ETH development board based on ESP32-S3R8, supports Wi-Fi and Bluetooth wireless communication, with reliable and efficient wired Ethernet ...



This is an ETH development board based on ESP32-S3R8, supports Wi-Fi and Bluetooth wireless communication, with reliable and efficient wired Ethernet connectivity, optional for PoE function.



It also features a W5500 Ethernet chip, enabling reliable wired Ethernet communication through a 10/100Mbps RJ45 port. The board is equipped with a ...

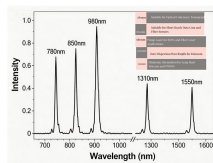

ESP32-S3 ETH Development Board, 10/100Mbps RJ45 Ethernet port, Wi-Fi & Bluetooth Support, 240MHz Dual Core Processor, ESP32 Ethernet Development Board This is an ETH development ...

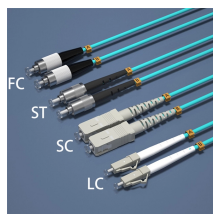

Buy 10/100mbps ethernet switch circuit board for module 10/100mbps 5port switch PCBA board OEM Motherboard ethernet switch 5 RJ45 at Aliexpress for . Find ...



This is an ETH development board based on ESP32-S3R8, supports Wi-Fi and Bluetooth wireless communication, with reliable and efficient wired Ethernet connectivity, optional for PoE function.



This is an ETH development board based on ESP32-S3R8, supports Wi-Fi and Bluetooth wireless communication, with reliable and efficient wired Ethernet connectivity, optional for PoE function.



This is an ETH development board based on ESP32-S3R8, supports Wi-Fi and Bluetooth wireless communication, with reliable and efficient wired Ethernet connectivity, optional for PoE function.



It also features a W5500 Ethernet chip, enabling reliable wired Ethernet communication through a 10/100Mbps RJ45 port. The board is equipped with a USB Type-C port for power supply, program ...

Contact Us

For more information, pricing, or custom network solutions, please contact us:

Website: <https://www.hashherbcafe.co.za>

Email: hello@hashherbcafe.co.za

Phone: +27 63 814 7295

Address: 15 Galaxy Road, Linbro Business Park, Johannesburg, 2065, South Africa

This document is for informational purposes only. Specifications subject to change without notice.

