

## Connection between metal cable trays and grounding mains

Component Diagram

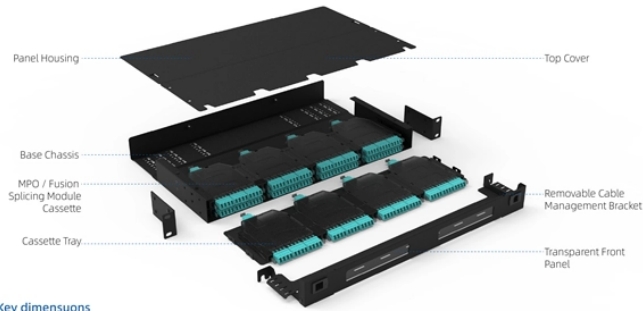

Key dimensions

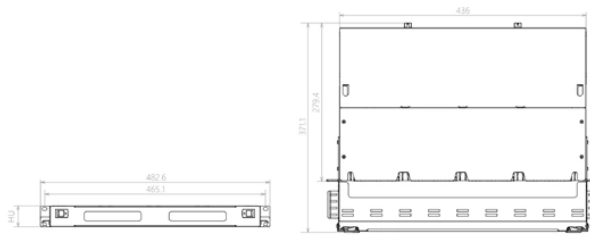

## Connection between metal cable trays and grounding mains



This comprehensive guide delves into the complexities of cable tray grounding, offering in-depth insights into its importance, principles, design considerations, installation best practices, and ...



The document discusses grounding and bonding practices for metallic and non-metallic cable trays. Metallic cable trays must be grounded and can serve as an ...



Connections of conduits and/or cables (Bonding and/or EGC) to the cable trays should be made with UL Listed Connectors that are properly installed to insure that there is good electrical continuity between ...



Discover the best practices for Cable Tray Grounding Wire installation. Learn key requirements, safety tips, and material choices to ensure a grounding system.



Learn the essential role of Equipment Grounding Conductors (EGC) in cable tray systems, including sizing requirements, installation standards, and NEC compliance for electrical safety.



All cable tray sections and fittings are legibly and durable marked to show the cross-sectional area of metal in channel cable trays, or cable trays of one-piece construction and the total cross-sectional ...



This comprehensive guide delves into the complexities of cable tray grounding, offering in-depth insights into its importance, principles, design ...



In addition to providing an electrical connection between the cable tray sections and the EGC, the grounding clamp mechanically anchors the EGC to the cable tray so that under fault current ...



Cables must be secured to the cable tray prior to and after the transition, and protected by guarding or location. The electrical connection between sections can be maintained with bonding jumpers or a ...



Copper stranded wire, galvanized flat steel, or metal components used to install supports along the cable trays can serve as the main grounding conductor. If the cable tray length is 30m or ...



All metallic cable trays shall be grounded as required in Article 250.96 regardless of whether or not the cable tray is being used as an equipment grounding conductor (EGC). The EGC ...

## Contact Us

For more information, pricing, or custom network solutions, please contact us:

Website: <https://www.hashherbcafe.co.za>

Email: [hello@hashherbcafe.co.za](mailto:hello@hashherbcafe.co.za)

Phone: +27 63 814 7295

Address: 15 Galaxy Road, Linbro Business Park, Johannesburg, 2065, South Africa

This document is for informational purposes only. Specifications subject to change without notice.

